



14 Crescent Road  
Caterham, Surrey, CR3 6LE

RAYNERS  
TOWN & COUNTRY

# 14 Crescent Road

Caterham, Surrey, CR3 6LE

- ✓ First floor maisonette
- ✓ Two bedrooms
- ✓ Living room
- ✓ Kitchen / Breakfast room
- ✓ Approx 90ft rear garden
- ✓ Off road parking
- ✓ Long lease

A Two bedroom first floor maisonette within walking distance to Caterham high street.

Accommodation comprises a living/dining room, two double bedrooms a family bathroom and a modern fitted kitchen. Externally the property has a private garden of approximately 90ft and off road parking which is accessed via mount pleasant road.

The property is conveniently located close to Caterham high street with its shops and amenities and also mainline train station.

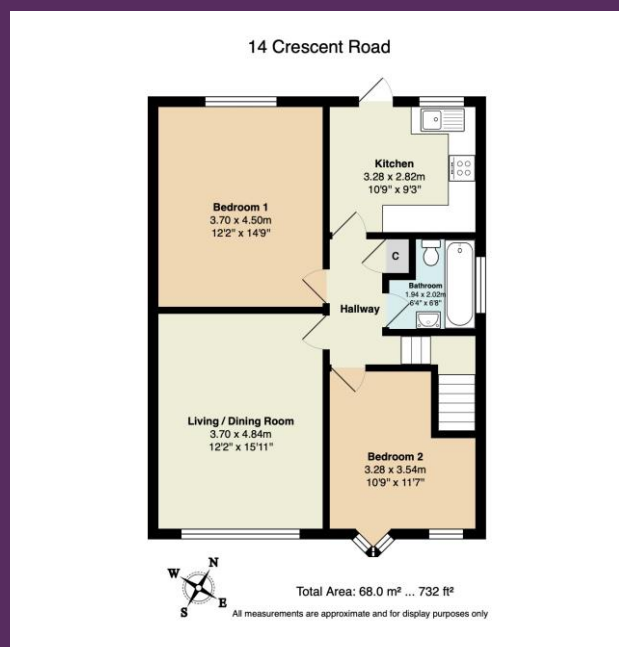

Tenure: Share of Freehold

Lease length: Approx 900 years.

The seller has advised no maintenance fees.

Local Authority: Tandridge District Council

Main Services: Gas, Electric & Water

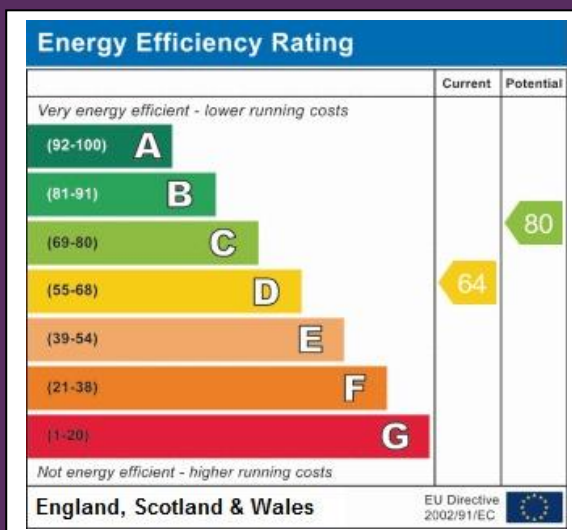

2 GLEBE ROAD, WARLINGHAM, SURREY, CR6 9NJ  
01883 622 258

warlingham@raynersproperties.com

www.raynersproperties.com

RAYNERS  
TOWN & COUNTRY

IMPORTANT: we would like to inform prospective purchasers that these sales particulars have been prepared as a general guide only. A detailed survey has not been carried out, nor the services, appliances and fittings tested. Room sizes should not be relied upon for furnishing purposes and are approximate. If floor plans are included, they are for guidance only and illustration purposes only and may not be to scale. If there are any important matters likely to affect your decision to buy, please contact us before viewing the property. R772